



Timber Court, Grays

£1,150 pcm

Ali & Co are delighted to present this FANTASTIC ONE DOUBLE BEDROOM GROUND FLOOR FLAT TO LET, Located in Timber Court on the popular riverside development in Grays.

Available to view now | Allocated Parking | Close to schools | Close To Station | Close to Town Centre | Fantastic Location | Ground Floor |

01375 806786

hello@aliandcoproperty.co.uk

Ali&Co
PROPERTY SERVICES

FANTASTIC 1 BEDROOM GROUND FLOOR FLAT

Ali & Co are delighted to present this FANTASTIC ONE DOUBLE BEDROOM GROUND FLOOR FLAT CHAIN FREE, Located in Timber Court on the popular riverside development in Grays.

LOCATION: The property is in a great location having stunning sunny riverside views in Grays Riverside, perfectly positioned on the the Ground floor ,Walking distance to Grays railway station, local amenities and Schools are all conveniently nearby.

ACCOMMODATION: The property offers excellent accommodation including an entrance hallway, the property features an impressive open plan kitchen, dining, and living area, along with a modern bathroom.

BEDROOMS: This property offers a great size double bedroom.

EXTERNALLY: There is allocated parking .

The property is offered CHAIN FREE , please call today to arrange a viewing.

Council Tax Band: B
Deposit: £1,150
Parking options: Residents
Electricity supply: Mains
Heating: Gas Mains
Water supply: Mains

Bedroom 1

w: 3.81m x l: 2.75m (w: 12' 6" x l: 9')

Lounge/diner

w: 4.9m x l: 3.27m (w: 16' 1" x l: 10' 9")

Kitchen

w: 1.62m x l: 2.82m (w: 5' 4" x l: 9' 3")





Ground Floor

Approx. 38.4 sq. metres (413.3 sq. feet)

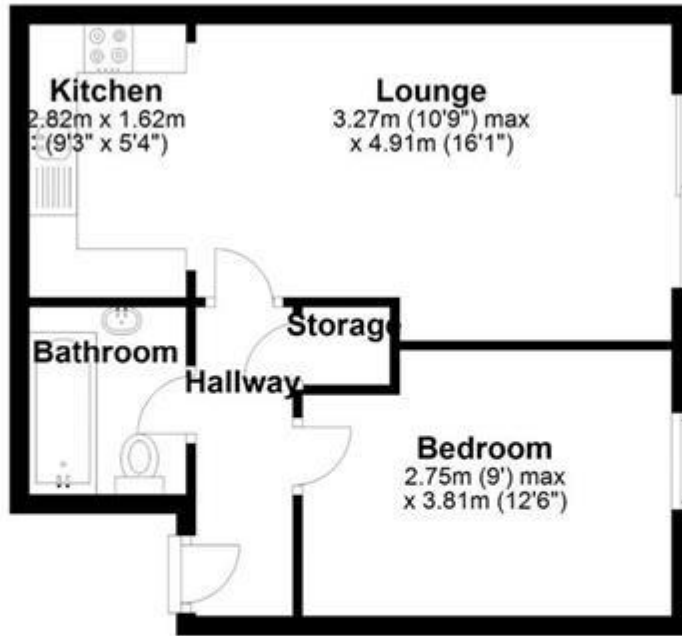

Total area: approx. 38.4 sq. metres (413.3 sq. feet)

All measurements have been taken as a guide to prospective buyers only and are not precise. This plan is for illustrative purposes only and no responsibility for any error, omission or misstatement. The services, systems and appliances shown have not been tested and no guarantee as to their operability or efficiency can be given. Measurements may have been taken from the widest area and may include wardrobe/cupboard space. No guarantee is given to any measurements including total areas. Buyers are advised to take their own measurements.

Plan produced using PlanUp.

Timber Court, Grays



Energy Efficiency Rating		
	Current	Potential
Very energy efficient - lower running costs		
(92-100) A		
(81-91) B		
(69-80) C		79
(55-68) D	64	
(39-54) E		
(21-38) F		
(1-20) G		
Not energy efficient - higher running costs		
England & Wales	EU Directive 2002/91/EC	

The energy efficiency rating is a measure of the overall efficiency of a home. The higher the rating the more energy efficient the home is and the lower the fuel bills will be.

Whilst every effort is made to ensure the accuracy of these details, it should be noted that the measurements are approximate only. Floorplans are for representation purposes only and prepared according to the RICS Code of Measuring Practice by our floorplan provider. Therefore, the layout of doors, windows and rooms are approximate and should be regarded as such by any prospective tenant.