



Dovestone Close, Grays

Guide Price £375,000 Freehold

GUIDE PRICE £375,000 -£385,000

Ali & Co are thrilled to introduce to the market this NEWLY BUILT TWO BEDROOM CHAIN FREE property located in the heart of LAKESIDE, West Thurrock.

CHAIN FREE | Cloakroom | Close Proximity To Lakeside Shopping Centre | Cul De Sac | Double Bedrooms | Ensuite Master Bedroom | Fantastic Location |

01375 806786

hello@aliandcoproperty.co.uk

Ali&Co
PROPERTY SERVICES

FANTASTIC TWO BEDROOM HOME

GUIDE PRICE £375,000 -£385,000

Ali & Co are thrilled to introduce to the market this NEWLY BUILT TWO BEDROOM CHAIN FREE property located in the heart of LAKESIDE, West Thurrock.

ACCOMMODATION: This newly-built home features a stunning kitchen with integrated appliances and a spacious lounge/dining area. There is also a downstairs WC.

The property features two spacious double bedrooms, with the master bedroom boasting the additional benefit of an en-suite.

This contemporary home boasts exceptional modern amenities, such as a sleek white fitted kitchen, alongside an elegantly fully tiled bathroom and en-suite.

EXTERNALLY: There is a beautiful low maintenance landscaped garden with rear access and allocated parking.

This property is ideal for first-time buyers, or investors looking for a stylish move in ready home in a sought after area. Internal viewings highly recommended , please call the office today on 01375 806786 to arrange a viewing of this beautifully presented home.

Council Tax Band: C (Thurrock Council)

Tenure: Freehold

Garden details: Rear Garden

Electricity supply: Mains, Solar

Heating: Gas Mains

Water supply: Mains

Accessibility measures: Wheelchair accessible

Bedroom 1

w: 4.2m x l: 3.1m (w: 13' 9" x l: 10' 2")

Bedroom 2

w: 4.2m x l: 2.27m (w: 13' 9" x l: 7' 5")

Lounge/diner

w: 3.68m x l: 4.3m (w: 12' 1" x l: 14' 1")

Kitchen

w: 2m x l: 3.4m (w: 6' 7" x l: 11' 2")





Ground Floor

Approx. 35.2 sq. metres (379.0 sq. feet)



First Floor

Approx. 33.6 sq. metres (362.0 sq. feet)

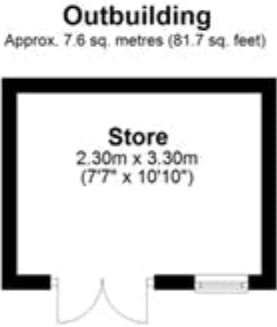
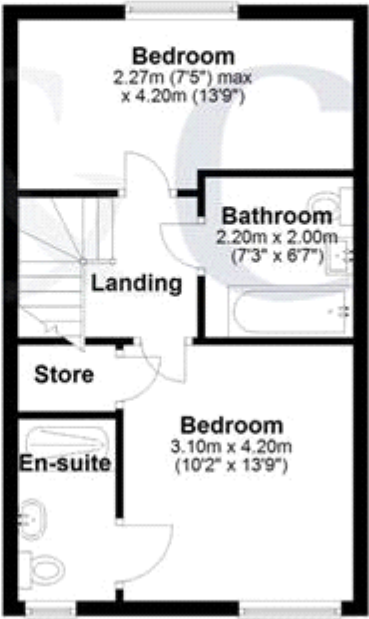

Total area: approx. 76.4 sq. metres (822.7 sq. feet)
Dovestone Close, Grays



Energy Efficiency Rating		
	Current	Potential
Very energy efficient - lower running costs		
(92+) A	95	120
(81-91) B		
(69-80) C		
(55-68) D		
(39-54) E		
(21-38) F		
(1-20) G		
Not energy efficient - higher running costs		
England & Wales		EU Directive 2002/91/EC

The energy efficiency rating is a measure of the overall efficiency of a home. The higher the rating the more energy efficient the home is and the lower the fuel bills will be.

Whilst every effort is made to ensure the accuracy of these details, it should be noted that the measurements are approximate only. Floorplans are for representation purposes only and prepared according to the RICS Code of Measuring Practice by our floorplan provider. Therefore, the layout of doors, windows and rooms are approximate and should be regarded as such by any prospective purchaser. Any internal photographs are intended as a guide only and it should not be assumed that any of the furniture/fittings are included in any sale. Where shown, details of lease, ground rent and service charge are provided by the vendor and their accuracy cannot be guaranteed, as the information may not have been verified and further checks should be made either through your solicitor/conveyance. Where appliances, including central heating, are mentioned, it cannot be assumed that they are in working order, as they have not been tested. Please also note that wiring, plumbing and drains have not been checked.