

Curzon Drive, Manor Way, Grays

£2,400,000 Freehold

Ali & Co are delighted to present this exceptional opportunity with FULL Planning Permission to develop 44 units, Located close to Grays Town Centre and Riverside.

Development Site With Planning Permission | 10% Affordable Housing | S106 & RAMS Contribution £159,045 | Prime Location | Close to Town Centre And Main Transport Links | Mix of 1,2 and 3 Bed Apartments |

01375 806786

hello@aliandcoproperty.co.uk

Ali&Co
PROPERTY SERVICES



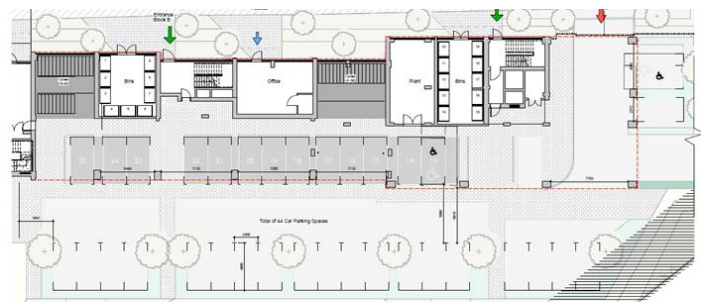

Proposed Car Park - West End
1:100

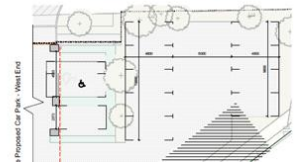

PROPOSED GROUND FLOOR - WEST END
1:100



PROPOSED FIRST FLOOR - WEST END
1:100



PROPOSED SECOND FLOOR - WEST END
1:100





Whilst every effort is made to ensure the accuracy of these details, it should be noted that the measurements are approximate only. Floorplans are for representation purposes only and prepared according to the RICS Code of Measuring Practice by our floorplan provider. Therefore, the layout of doors, windows and rooms are approximate and should be regarded as such by any prospective purchaser. Any internal photographs are intended as a guide only and it should not be assumed that any of the furniture/fitings are included in any sale. Where shown, details of lease, ground rent and service charge are provided by the vendor and their accuracy cannot be guaranteed, as the information may not have been verified and further checks should be made either through your solicitor/conveyance. Where appliances, including central heating, are mentioned, it cannot be assumed that they are in working order, as they have not been tested. Please also note that wiring, plumbing and drains have not been checked.