



Tasker Road, Grays

£370,000 Freehold

Ali & Co are delighted to have on offer this fantastic Three Bedroom Two Reception Room family home, Decorated to a very high standard.

CLOSE TO TOWN | Double Glazing | Integrated Appliances | Off-street parking | Semi Detached House | Three Bedrooms | Wood Flooring | Porch |

01375 806786

hello@aliandcoproperty.co.uk

Ali&Co
PROPERTY SERVICES

STUNNING THREE BEDROOM FAMILY HOME

Ali & Co are delighted to have on offer this fantastic Three Bedroom Two Reception Room family home, the property offers fantastic living space with spacious lounge, leading through to the dining room and separate kitchen with granite work surfaces.

The property also benefits from having a downstairs WC, ample parking space, porch, a large shed in the rear garden. Three very good size bedrooms and a family bathroom. Decorated to a very high standard.

Viewings highly recommended.

Council Tax Band: C (Thurrock Council)

Tenure: Freehold

Parking options: Off Street

Garden details: Private Garden





GROUND FLOOR



1ST FLOOR

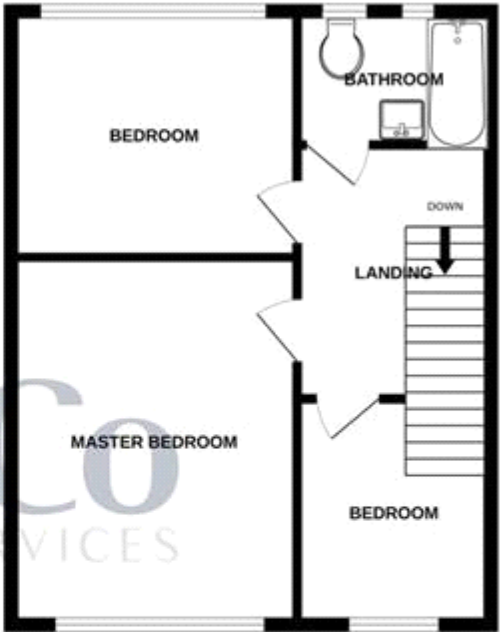

Whilst every attempt has been made to ensure the accuracy of the floorplan contained here, measurements of doors, windows, rooms and any other items are approximate and no responsibility is taken for any error, omission or mis-statement. This plan is for illustrative purposes only and should be used as such by any prospective purchaser. The services, systems and appliances shown have not been tested and no guarantee as to their operability or efficiency can be given.
Made with Metropix 4/2025



Energy Efficiency Rating		
	Current	Potential
Very energy efficient - lower running costs		
(92-100) A		
(81-91) B		86
(69-80) C		
(55-68) D	70	
(39-54) E		
(21-38) F		
(1-20) G		
Not energy efficient - higher running costs		
England & Wales		EU Directive 2002/91/EC

The energy efficiency rating is a measure of the overall efficiency of a home. The higher the rating the more energy efficient the home is and the lower the fuel bills will be.

Whilst every effort is made to ensure the accuracy of these details, it should be noted that the measurements are approximate only. Floorplans are for representation purposes only and prepared according to the RICS Code of Measuring Practice by our floorplan provider. Therefore, the layout of doors, windows and rooms are approximate and should be regarded as such by any prospective purchaser. Any internal photographs are intended as a guide only and it should not be assumed that any of the furniture/fitings are included in any sale. Where shown, details of lease, ground rent and service charge are provided by the vendor and their accuracy cannot be guaranteed, as the information may not have been verified and further checks should be made either through your solicitor/conveyance. Where appliances, including central heating, are mentioned, it cannot be assumed that they are in working order, as they have not been tested. Please also note that wiring, plumbing and drains have not been checked.