



Clarkebourne Drive, Grays

£425,000 Freehold

Ali & Co Property Services are delighted to present this well-maintained three-bedroom semi-detached family home, ideally situated on the highly sought-after Clarkebourne Drive in Grays.

Available to view now | Detached Garage | Driveway | Ideal family home | No Onward Chain | Three bedroom family home | Close to Schools, Shops & Transport Links | Downstairs WC |

01375 806786

hello@aliandcoproperty.co.uk

Ali&Co
PROPERTY SERVICES

Spacious Three Bedroom Semi-Detached Family Home with Garage & Private Garden

Ali & Co Property Services are delighted to offer for sale this well-maintained three-bedroom semi-detached family home, ideally situated on the highly sought-after Clarkebourne Drive, Grays. Offering generous living accommodation, a detached garage, ample off-street parking and excellent potential to extend further (subject to the necessary planning permissions), this property is an ideal purchase for growing families and first-time buyers alike.

Upon entering, you are welcomed by a bright entrance porch leading into a spacious hallway. The property boasts a generous living room filled with natural light, creating the perfect space for relaxing and entertaining. To the rear, the home features a fitted open-plan kitchen and dining area, providing an excellent social space for modern family living and offering lovely views over the garden. The ground floor also benefits from a convenient WC, adding practicality for families and visiting guests.

The first floor offers three well-proportioned bedrooms, comprising two generous double bedrooms and a comfortable single bedroom. These are serviced by a modern shower room, finished to a good standard and designed for practical family living.

Externally, the property benefits from a private rear garden, detached garage and a driveway providing off-street parking for multiple vehicles. There is also excellent potential for an outbuilding or garden room (subject to the necessary permissions), with works already having commenced, creating an exciting opportunity for buyers to further enhance the property and tailor it to their own requirements.

Lovingly maintained by the current owners, this fantastic home offers spacious accommodation, future potential and a highly desirable location, making it a wonderful choice for families looking to move straight in while retaining scope for future improvements.

Conveniently located close to local schools, shops, parks and transport links including Grays Town Centre and C2C rail services, this property offers the perfect balance of family living and commuter convenience.

Early viewing is highly recommended.

Property Features

- Three Bedroom Semi-Detached House
- Spacious Living Room
- Separate Dining Room
- Fitted Kitchen
- Ground Floor WC
- Modern Family Bathroom
- Detached Garage
- Private Driveway with Off Street Parking
- Private Rear Garden
- Potential to Extend (STPP)
- Popular Residential Location
- Close to Schools, Shops & Transport Links
- Ideal Family Home
- Accommodation

Ground Floor

- Entrance Porch
- Entrance Hall
- Living Room – 17'1" x 10'5"
- Kitchen – 15'11" x 6'10"
- Dining Room – 10'5" x 8'3"



Ground Floor WC
Storage Cupboard

First Floor

Bedroom One – 12'5" x 10'5"

Bedroom Two – 10'9" x 10'6"

Bedroom Three – 8'9" x 5'9"

Family Bathroom

Outside

Front Garden

Driveway

Detached Garage

Private Rear Garden

Location

Clarkebourne Drive is a popular residential road within Grays, offering excellent access to highly regarded local schools, supermarkets, parks and leisure facilities. Grays Railway Station provides direct C2C services into London Fenchurch Street, while the A13 and M25 are easily accessible, making this an excellent location for commuters.

Viewing is strictly by appointment through Ali & Co Property Services. Contact our sales team today to arrange your viewing.

Council Tax Band: C (Thurrock Council)

Tenure: Freehold

Parking options: Driveway, Garage

Garden details: Front Garden, Private Garden, Rear Garden

Electricity supply: Mains

Heating: Gas Mains

Water supply: Mains

Sewerage: Mains



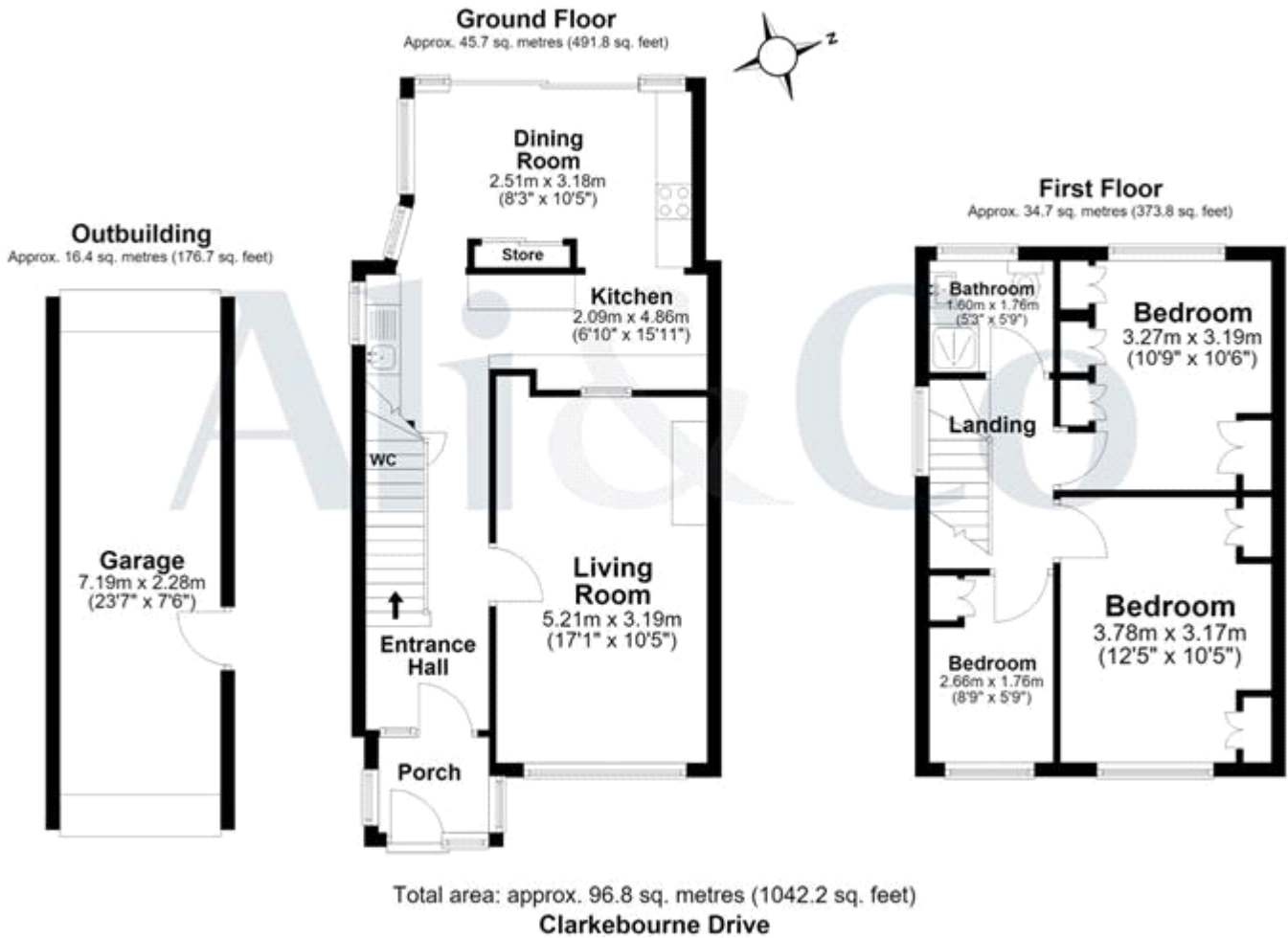

Whilst every effort is made to ensure the accuracy of these details, it should be noted that the measurements are approximate only. Floorplans are for representation purposes only and prepared according to the RICS Code of Measuring Practice by our floorplan provider. Therefore, the layout of doors, windows and rooms are approximate and should be regarded as such by any prospective purchaser. Any internal photographs are intended as a guide only and it should not be assumed that any of the furniture/fittings are included in any sale. Where shown, details of lease, ground rent and service charge are provided by the vendor and their accuracy cannot be guaranteed, as the information may not have been verified and further checks should be made either through your solicitor/conveyance. Where appliances, including central heating, are mentioned, it cannot be assumed that they are in working order, as they have not been tested. Please also note that wiring, plumbing and drains have not been checked.